



Electrical Specifications

Center Frequency: 3500 MHz
Bandwidth: 300 MHz
Pass Band: 3350-3650 MHz
Pass Band Insertion Loss: 1.5 dB Max
Pass Band Ripple: 0.65 dB Max
Pass Band Return Loss: 12 dB Min
Attenuation: >40 dB @ 0.1-2664 MHz
 >30 dB @ 2664-3132 MHz
 >20 dB @ 3868-4068 MHz
Input Power: 2 Watts Max

Mechanical

Mounting Method: SMT
Dimensions: 10.20 x 4.10 x 3.80 mm

Environmental

Operating Temperature: -40 to +85° C
Storage Temperature: -50 to +95° C
Shock: 20 G. 11 ms
Vibration: 20 G. 5 to 200 MHz

Outline Drawing:

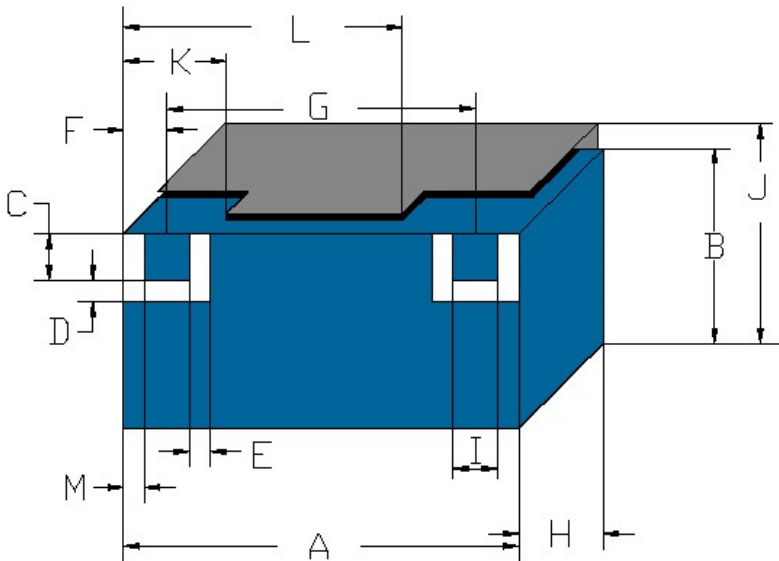

Dim	Nominal (mm)	Tolerance (mm) +/- or max
A	10.20	Max
B	3.80	Max
C	1.00	0.13
D	0.60	0.13
E	0.60	0.13
F	1.20	0.13
G	7.80	0.13
H	4.10	Max
I	1.00	0.13
J	4.90	Max
K	2.54	0.25
L	7.40	0.25
M	0.65	0.20



Response Plot:

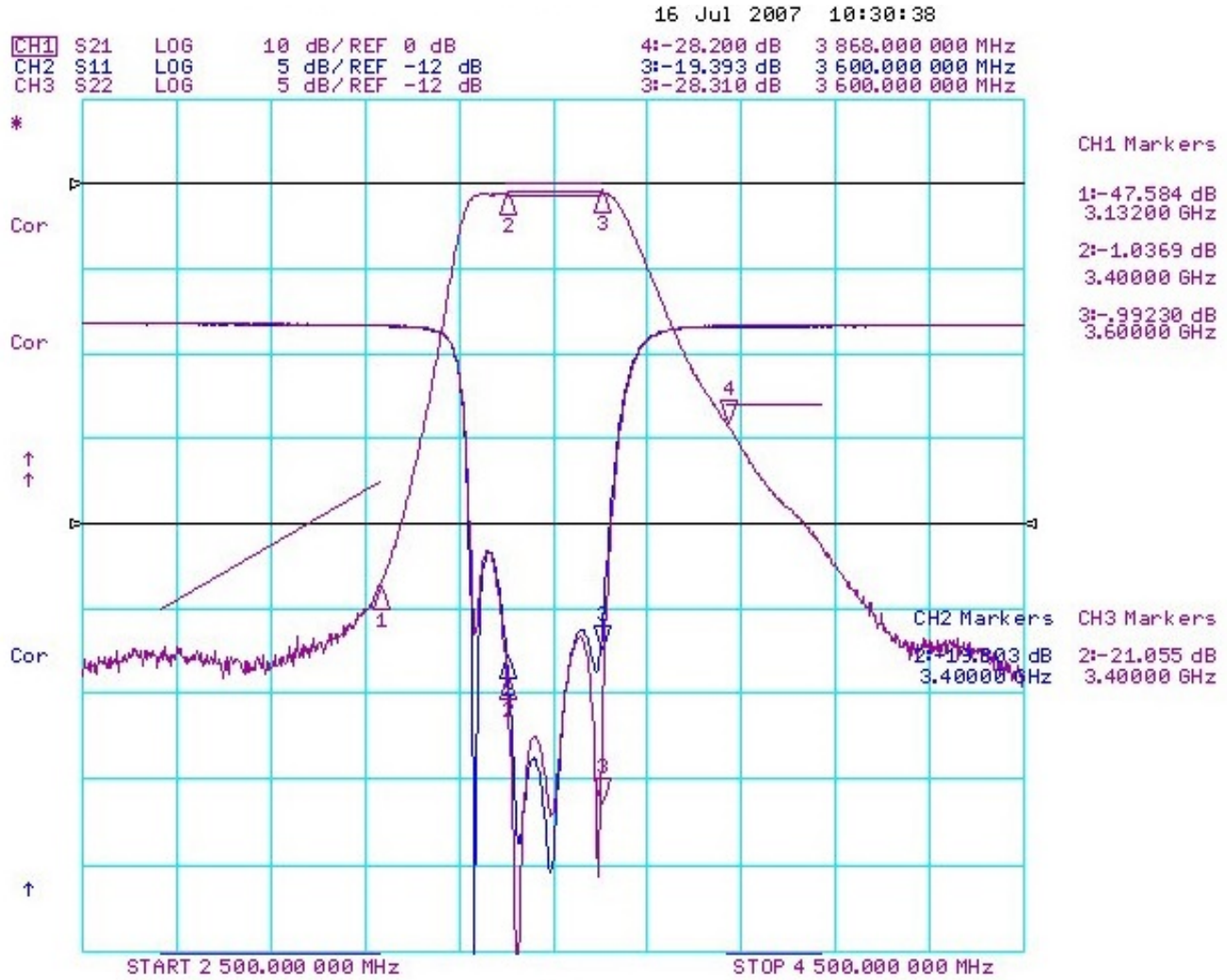



PCB Layout:

