

RECOMMENDED P.C.B LAYOUT
GENERAL TOLERANCE:±0.05

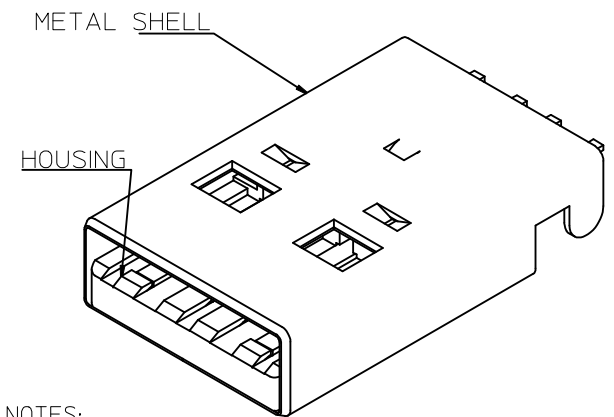

- NOTES:
- MATERIAL:
HOUSING: LCP, GLASS FIBER FILLED, UL94V-0, COLOR: BLACK.
TERMINAL: BRASS
METAL SHELL: COLD ROLL STEEL
 - FINISH:
TERMINAL:
SELECTIVE GOLD(Au) IN CONTACT AREA
THICKNESS=30 MICROINCH MINIMUM.
SELECTIVE TIN(Sn), ALLOY IN SOLDER TAIL AREA
THICKNESS=120 MICROINCH MINIMUM.
UNDER PLATED: NICKEL(Ni), THICKNESS=50 MICROINCH MINIMUM.
METAL SHELL:
NICKEL(Ni), OVERALL
UNDER PLATE: COPPER(Cu), OVERALL
THICKNESS=50 MICROINCH MINIMUM.
 - RECOMMENDED PCB THICKNESS: 1.60±0.05mm
 - PRODUCT SPECIFICATION: REFERS TO PS-48037-001
 - PACKAGE SPECIFICATION REFERS TO PK-48037-210
 - TEST SUMMARY REFERS TO TS-48037-001
 - COPLANARITY TO BE 0.1mm MAX.
 - LEAD FREE AND ROHS COMPLIANCE.
 - DATE CODE: xx xx x
YEAR WEEK DAY

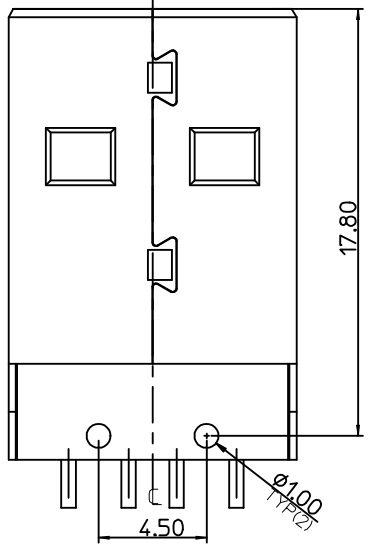
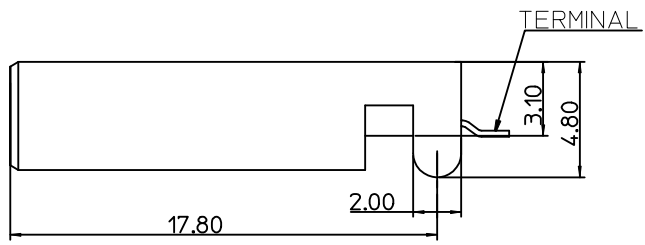
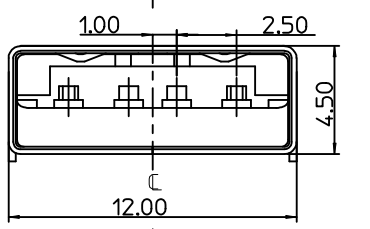

REVISE EC NO:SH2016-0141 DRWN: F YANG05 2015/10/30 CHKD: APPR: RZHANG 2015/11/06	QUALITY SYMBOLS F=0 F=0 F=0	GENERAL TOLERANCES (UNLESS SPECIFIED)		DIMENSION STYLE MM ONLY		SCALE 1:1	DESIGN UNITS	THIRD ANGLE PROJECTION			
		4 PLACES ± --- ± ---	3 PLACES ± --- ± ---	2 PLACES ± 0.25 ± ---	1 PLACE ± 0.25 ± ---	DRAWN BY CHERRY	DATE 2005/05/25	TITLE USB A TYPE PLUG WITH STR SHELL LEG(4.8MM)SMT (LEAD-FREE VERSION)			
		ANGULAR ± 3 °				APPROVED BY WILSON	DATE 2005/05/26				
		DRAFT WHERE APPLICABLE MUST REMAIN WITHIN DIMENSIONS				MATERIAL NO. 48037-2100	DOCUMENT NO. SD-48037-003	SHEET NO. 1 OF 1			