

PART NUMBER	NUMBER OF WIRE OPENINGS	CIRCUIT POSITION	WIRE SIZE(S) SEE NOTE 6	WIRE HOLE DIAMETER
46396-5201	3	1, 2, 3	16 AWG	2.34/.092
46396-5202	2	4, 5	10 AWG	4.46/.176
46396-5203	3	3, 4, 5	16 AWG	2.74/.108
46396-5204	3	1, 2, 3	12 AWG	3.92/.154
46396-5205	3	1, 2, 3	10 AND 12 AWG	(214,34/.172 114,74/.188)
46396-5211	3	1, 2, 3	16 AWG	2.74/.108
46396-5231	5	1, 2, 3, 4, 5	12 AWG	4.00/.158

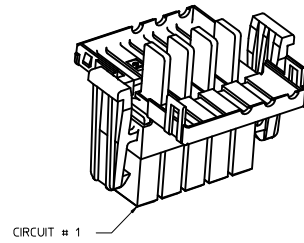

CIRCUIT # 1

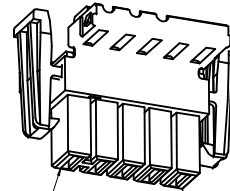

POLARIZATION LOCATION  
CIRCUIT # 1

- NOTES:
1. MATERIAL: PBT OR EQUIVALENT, 94V-0. COLOR: BLACK
  2. HOUSING ACCEPTS MOLEX TERMINAL SERIES: 44262-4\*\*\*\* (SEE MOLEX DRAWING NUMBER SD-44262-001 FOR TERMINAL OPTIONS)
  3. HOUSING AND ASSOCIATED COMPONENTS ARE RoHS COMPLIANT
  4. PACKAGED PER MOLEX PACKAGING SPEC: PK-46396-\*\*\*\*
  5. RECEPTACLE HOUSING MATES WITH PLUG HOUSING 46394-5001 (SEE MOLEX DRAWING NUMBER SD-46394-001 FOR DETAILS)
  6. FINAL FIT OF WIRE THRU WIRE OPENINGS WILL DEPEND ON THE OUTSIDE DIAMETER OF THE WIRE.

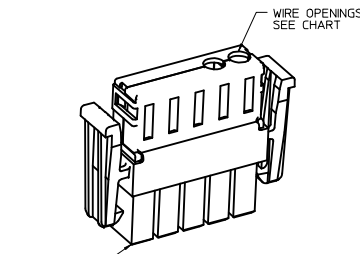
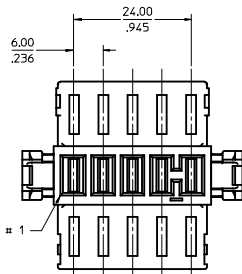
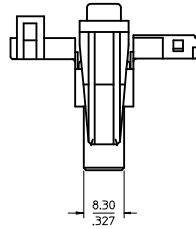
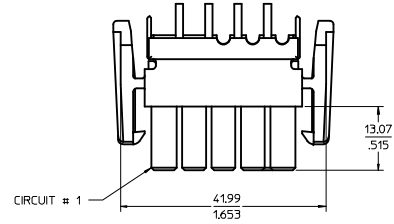
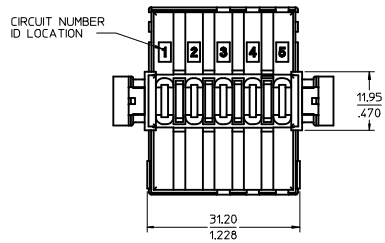

CIRCUIT # 1  
46396-5202

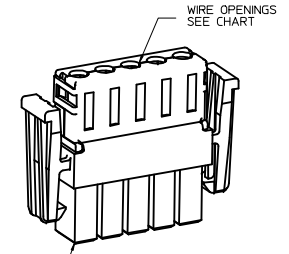

CIRCUIT # 1  
46396-5231

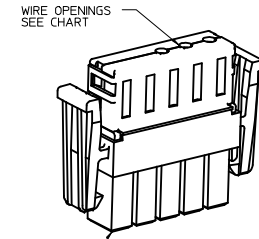

CIRCUIT # 1  
46396-5203

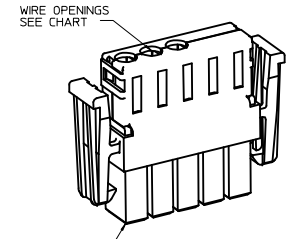

CIRCUIT # 1  
46396-5201, 46396-5204,  
46396-5205 AND 46396-5211

WIRE OPENING CONFIGURATIONS  
CONNECTORS SHOWN CLOSED

<b>ADD PART NOS TO CHG</b> EC NO: UCP2009-0623 DRAWN DATA: 2008/09/23 CHYK: 2008/09/23 APPR: JCOMERCL APPR: JCOMERCL REV: 2008/10/03	QUALITY SYMBOLS	GENERAL TOLERANCES (UNLESS SPECIFIED)	DIMENSION STYLE	SCALE	DESIGN UNITS	THIRD ANGLE PROJECTION	
	▽=0	mm INCH	MM/IN	2:1	METRIC	⊙ □	
	▽=0	4 PLACES ± --- ± --- 3 PLACES ± --- ± .005 2 PLACES ± 0.13 ± .010 1 PLACE ± 0.25 ± --- ANGULAR ±1/2°	DRAWN BY DATE MATA 07-10-07	CHECKED BY DATE MATA 2007/01/15	TITLE RECEPTACLE HOUSING 5 POSITION WITH LATCH POWER CONNECTOR	MOLEX INCORPORATED	
	▽=0	DRAFT WHERE APPLICABLE MUST REMAIN WITHIN DIMENSIONS	APPROVED BY DATE APATEL 2007/01/15	MATERIAL NO. SEE CHART	DOCUMENT NO. SD-46396-101	SHEET NO. 1 OF 1	